

+NOTICE!!

These documents have been scanned!

Do not place un-scanned documents beneath this notice!

Do not remove this notice from this file!

GPO Jacket No. 560-102
Print Order 61540
Rise Business Services, LLC
Job=AZ15 9/11/2019



Box Number= AZ15231



Claim Begin-End: AMC450741-AMC450750

1 Initial Receipt



AZ15231-5

AMC430131-AMC453855

United States Department of the Interior
Bureau of Land Management
 DIV OF LANDS, MINRLS & ENERGY
 ONE N CENTRAL AVE
 PHOENIX, AZ 85004 -4427
 Phone: 602-417-9200

Receipt

No: 4160829

Transaction #: 4275096	
Date of Transaction: 05/11/2018	
CUSTOMER:	
FIRST WESTERN RESOURCES INC 24 W CAMELBACK RD STE A-563 PHOENIX,AZ 85013-2529 US	

ENTERED
MAY 16 2018
 BY: Ram

LINE #	QTY	DESCRIPTION	REMARKS	UNIT PRICE	TOTAL
1	10.00	LOCATABLE MINERALS / MINING CLAIMS-NEW,UNADJUD, ONE OR MORE AUTH NOS / NEW MINING CLAIM PROCESSING FEE CASES: AMC450741/\$20.00, AMC450742/\$20.00, AMC450743/\$20.00, AMC450744/\$20.00, AMC450745/\$20.00, AMC450746/\$20.00, AMC450747/\$20.00, AMC450748/\$20.00, AMC450749/\$20.00, AMC450750/\$20.00		- n/a -	200.00
2	10.00	LOCATABLE MINERALS / MINING CLAIMS-NEW,UNADJUD, ONE OR MORE AUTH NOS / NEW MINING CLAIMS LOCATION FEE CASES: AMC450741/\$37.00, AMC450742/\$37.00, AMC450743/\$37.00, AMC450744/\$37.00, AMC450745/\$37.00, AMC450746/\$37.00, AMC450747/\$37.00, AMC450748/\$37.00, AMC450749/\$37.00, AMC450750/\$37.00		- n/a -	370.00
3	10.00	LOCATABLE MINERALS / MINING CLAIMS-NEW,UNADJUD, ONE OR MORE AUTH NOS / NEW MINING CLAIMS MAINTENANCE FEE CASES: AMC450741/\$155.00, AMC450742/\$155.00, AMC450743/\$155.00, AMC450744/\$155.00, AMC450745/\$155.00, AMC450746/\$155.00, AMC450747/\$155.00, AMC450748/\$155.00, AMC450749/\$155.00, AMC450750/\$155.00		- n/a -	1550.00
TOTAL:					\$2,120.00

PAYMENT INFORMATION			
1	AMOUNT:	2120.00	POSTMARKED: N/A

TYPE:	CHECK	RECEIVED: 05/11/2018
CHECK NO:	230	
NAME:	FIRST WESTERN RESOURCES INC 5025 N CENTRAL AVE STE 583 STE A-563 PHOENIX AZ 85013-2529 US	

REMARKS

This receipt was generated by the automated BLM Collections and Billing System and is a paper representation of a portion of the official electronic record contained therein.

NOTICE!!

These documents have been scanned!

Do not place un-scanned documents beneath this notice!

Do not remove this notice from this file!

GPO Jacket No. 560-102
Print Order 61540
Rise Business Services, LLC
Job=AZ15 9/11/2019



Box Number= AZ15231



Claim Begin-End: AMC450741-AMC450750

2 Correspondence



AZ15231-5

AMC430131-AMC453855

**NO
DOCUMENTS
FOUND**

NO DOCUMENTS FOUND
NO DOCUMENTS FOUND

NOTICE!!

These documents have been scanned!

Do not place un-scanned documents beneath this notice!

Do not remove this notice from this file!

GPO Jacket No. 560-102
Print Order 61540
Rise Business Services, LLC
Job=AZ15 9/11/2019



Box Number= AZ15231



Claim Begin-End: AMC450741-AMC450750

3 Transfers



AZ15231-5

AMC430131-AMC453855

**NO
DOCUMENTS
FOUND**

NO DOCUMENTS FOUND
NO DOCUMENTS FOUND

NOTICE!!

These documents have been scanned!

Do not place un-scanned documents beneath this notice!

Do not remove this notice from this file!

GPO Jacket No. 560-102
Print Order 61540
Rise Business Services, LLC
Job=AZ15 9/11/2019



Box Number= AZ15231



Claim Begin-End: AMC450741-AMC450750

4 Annual Filings



AZ15231-5

AMC430131-AMC453855

Amc 439460

450741

SHEET ① OF ②

MAINTENANCE FEE PAYMENT

Claimant Name: FIRST WESTERN GOLD INC.
 Address: 24 W. CAMELBACK RD #503
 City: PHOENIX State: AZ Zip: 85012
 Telephone: 817-913-2552
 E-mail address: FIRSTWESTERNGOLD@ATT.NET
 Signature: [Signature]
 Check here if this is a change of address.

RECEIVED
 ARIZONA STATE OFFICE
 2018 AUG 28 A 11:09
 PHOENIX, ARIZONA
 BLM
 Date
 Stamp

LINE NO.	AMC NUMBER	CLAIM/SITE NAME	COUNTY RECORDER DATA (If available)	TWP	RNG	SEC
1	450750	FWG 100	2018-005319	7N	13E	35/36
2	439463	FWG 101	2018-005320	7N	13E	36
3	439462	FWG 102	2018-005321	7N	13E	36
4	439461	FWG 103	2018-005322	7N	13E	36
5	439460	FWG 104	2018-005323	7N	13E/14E	36/31
6	450741	FWG 5	2018-005324	7N	14E	31
7	450742	FWG 6	2018-005325	7N	13E	36
8	450743	FWG 7	2018-005326	7N	13E	36
9	450744	FWG 8	2018-005327	7N	13E	36
10	450745	FWG 9	2018-005328	7N	13E/14E	36/31

List additional claims on Form MCF114.

Bureau of Land Management
 Arizona State Office
www.blm.gov/az/

No. of Claims*: _____ x \$155 = _____
 Check No: _____ Init. _____
 Receipt No.: 4247360
 For BLM Use Only
 ENTERED AUG 29 2018
 AC 182
 PB

* \$155 per lode mining claim, mill site, or tunnel site; and \$155 for each 20 acres or portion thereof for each placer mining claim.

Form: MCF112
 Revised July 2014

SHEET (2) OF (2)

MAINTENANCE FEE PAYMENT

Claimant Name: FIRST WESTERN GOLD INC.
 Address: 24 W. CAMELBACK RD. #563
 City: PHOENIX State: AZ Zip: 85012
 Telephone: 817 913 2552
 E-mail address: FIRSTWESTERNGOLD@ATT.NET
 Signature: [Handwritten Signature]

RECEIVED
 314 AZ STATE OFFICE
 2018 AUG 28 A 11:09
 PHOENIX, ARIZONA
 BLM
 Date
 Stamp

Check here if this is a change of address.

LINE NO.	AMC NUMBER	CLAIM/SITE NAME	COUNTY RECORDER DATA (If available)	TWP	RNG	SEC
1	450746	FWG 10	2018-005329	7N	13E	36
2	450747	FWG 11	2018-005330	7N	13E	36
3	450748	FWG 12	2018-005331	7N	13E	36
4	450749	FWG 13	2018-005332	7N	13E 14E	36 31
5						
6						
7						
8						
9						
10						

List additional claims on Form MCF114.

No. of Claims*: _____ x \$155 = _____
 Check No: _____ Init. _____
 Receipt No.: _____
 For BLM Use Only

Bureau of Land Management
 Arizona State Office
www.blm.gov/az/

* \$155 per lode mining claim, mill site, or tunnel site; and \$155 for each 20 acres or portion thereof for each placer mining claim.

Form: MCF112
 Revised July 2014

United States Department of the Interior
Bureau of Land Management
 DIV OF LANDS, MINRLS & ENERGY
 ONE N CENTRAL AVE
 PHOENIX, AZ 85004 -4427
 Phone: 602-417-9200

Receipt

No: 4247366

Transaction #: 4362836	
Date of Transaction: 08/28/2018	
CUSTOMER:	
FIRST WESTERN RESOURCES INC 24 W CAMELBACK RD STE A-563 PHOENIX, AZ 85013-2529 US	

AC 782

ENTERED AUG 29 2018

FB

LINE #	QTY	DESCRIPTION	REMARKS	UNIT PRICE	TOTAL
1	1.00	LOCATABLE MINERALS / MINING CLAIMS- NOT NEW-UNADJUD, ONE AUTH NO. ONLY / MINING CLAIM MONEY RECEIVED CASES: AMC450750/\$2170.00	MAINT 2019/14	- n/a -	2170.00
TOTAL:					\$2,170.00

PAYMENT INFORMATION					
1	AMOUNT:	2170.00	POSTMARKED:	N/A	
	TYPE:	CASH	RECEIVED:	08/28/2018	
	NAME:	FIRST WESTERN RESOURCES INC 24 W CAMELBACK RD STE A-563 PHOENIX AZ 85013-2529 US			

REMARKS

This receipt was generated by the automated BLM Collections and Billing System and is a paper representation of a portion of the official electronic record contained therein.

NOTICE!!

These documents have been scanned!

Do not place un-scanned documents beneath this notice!

Do not remove this notice from this file!

GPO Jacket No. 560-102
Print Order 61540
Rise Business Services, LLC
Job=AZ15 9/11/2019



Box Number= AZ15231



Claim Begin-End: AMC450741-AMC450750

5 Miscellaneous



AZ15231-5

AMC430131-AMC453855

**NO
DOCUMENTS
FOUND**

NO DOCUMENTS FOUND
NO DOCUMENTS FOUND

NOTICE!!

These documents have been scanned!

Do not place un-scanned documents beneath this notice!

Do not remove this notice from this file!

GPO Jacket No. 560-102
Print Order 61540
Rise Business Services, LLC
Job=AZ15 9/11/2019



Box Number= AZ15231



Claim Begin-End: AMC450741-AMC450750

6 Location Notices-Amendments and Supporting Documents



AZ15231-5

AMC430131-AMC453855

MINING CLAIM STATUS REPORT

Data Entered: 5/16/18 Ram

MTP Checked By: MLL
GEO Checked By: MLL

LEAD SERIAL NUMBER: AMC 450741 thru AMC 450750

NUMBER OF CLAIMS & TYPE:

10 LODE
PLACER
ASSOCIATION PLACER
MILL SITE
TUNNEL SITE

CHARGES:

Processing Fee @ \$20 = \$ 200
Location Fee @ \$37 = \$ 370
Maintenance Fee @ \$155 = \$ 1,550
Add'l Maint Fee for Assoc Placer = \$
SUBTOTAL \$
Other Fees \$
Other Fees \$
TOTAL \$ 2,120

TOTAL ACREAGE: _____ Per Claim
(Placer Only)

NUMBER OF LOCATORS: _____

DOCUMENTS RECEIVED VIA: Over-the-Counter [] Mail [] TIMELY FILED: Yes [] No []

LEGAL DESCRIPTION: T 7N R 14E SEC 31
T 7N R 13E SEC 30, 35
T _____ R _____ SEC _____
T _____ R _____ SEC _____
T _____ R _____ SEC _____

BLM [] FOREST SERVICE [] SUBJ TO PL 359: Yes [] No []
WILDERNESS AREA []

SPLIT ESTATE: N/A [] SX [] PX [] OTHER []
SRHA [] Was proper Notice filed if located on SHRA Land? Yes [] No []

RECONVEYED MINERALS ON BLM LAND REQUIRE OPENING ORDER FROM 1944 TO 1993:
Open to Entry On _____ N/A []

COMMENTS/STATUS: VOID [] PARTIALLY VOID [] PVT MINERALS [] WITHDRAWN LANDS []
OTHER [] M&B's Required w/ M&B Desc

[] Claimant acknowledges that portions of the following claim(s) site(s) may be void or voidable.

Printed Name of Claimant _____ Signature of Claimant _____

*****FINAL ADJUDICATION*****

DATE 8/8/18 INITIALS MB

AMC 450741

LOCATION NOTICE FOR LODE MINING CLAIM

Amendment BLM Serial # _____

NOTICE IS HEREBY GIVEN that the FWG-5
_____ lode mining claim has been located
by First Western Gold, Inc whose current mailing
address is 24 W. Camelback Rd, # 563
Phoenix, AZ. 85012

RECEIVED
BLM AZ STATE OFFICE
2018 MAY 11 A 11:38
PHOENIX, ARIZONA
BLM
Date
Stamp

The general course of this claim is East/West and it is situated in Gila
County, Arizona. This claim is 1500 feet in length and 600 feet in width.

20.6 Total Claim Acreage. This claim runs from the location monument on which this location notice
is posted on the centerline of the claim approximately 20 feet in a West direction to the West
end line and 1480 feet in a East direction to the East end line. This claim is marked by six
monuments, one at each corner and one at the center of each end line of the claim.

The location monument on which this notice is posted is situated within Section 31, Township 7N
_____, Range 14 E, Gila Salt River Base and Meridian, Arizona and this claim encompasses portions
of the following quarter section(s), section(s), Township(s) and Range(s) ~~SW 1/4, Sec. 31, T7N, R14E~~
SW 1/4, Sec. 31, T7N, R14E

Gila Salt River Base and Meridian, Arizona.

The locality of this claim with reference to some natural object or permanent monument and additional information
(if any) concerning its locality are as follows: the SEC of this claim bears N71-59E,
2610' from the monument at the intersection of T6N, T7N, R13E,
and R14E

The above information is shown on the attached map.

DATED AND POSTED on the ground this 1 day of MAY, 2018.

LOCATOR(s) AGENT

Print Name(s) Alfred De Falco Pres., F.W.G.

Signature(s) [Signature] F.W.G. PRES

Form MCF100
Revised July 2014

AMC450741

RECEIVED
PHOENIX STATE OFFICE
2014 MAY 11 A 11:39
PHOENIX, ARIZONA

LOCATION NOTICE FOR LODE MINING CLAIM

Amendment BLM Serial # _____

NOTICE IS HEREBY GIVEN that the F.W.G-6

_____ lode mining claim has been located

by First Western Gold, Inc whose current mailing address is 24 W. Camelback Rd., #563 Phoenix, AZ. 85012

BLM
Date
Stamp

The general course of this claim is East/West and it is situated in Gila

County, Arizona. This claim is 1500 feet in length and 600 feet in width.

20.6 Total Claim Acreage. This claim runs from the location monument on which this location notice is posted on the centerline of the claim approximately 1480 feet in a West direction to the West end line and 20 feet in a East direction to the East end line. This claim is marked by six monuments, one at each corner and one at the center of each end line of the claim.

The location monument on which this notice is posted is situated within Section 36, Township 7

N, Range 13 E, Gila Salt River Base and Meridian, Arizona and this claim encompasses portions

of the following quarter section(s), section(s), Township(s) and Range(s) SW 1/4, Sec 36, T7N, R13E

Gila Salt River Base and Meridian, Arizona.

The locality of this claim with reference to some natural object or permanent monument and additional information (if any) concerning its locality are as follows: the SEC bears N 82° W, 3594' from the monument at the intersection of T6N, T7N, R13E, & R14E

The above information is shown on the attached map.

DATED AND POSTED on the ground this 1 day of MAY, 2018

LOCATOR(s) AGENT

Print Name(s) Alfred DeFalco Pres. F.W.G.

Signature(s) [Handwritten Signature] PRES

Form MCF100
Revised July 2014

ANCI450742

LOCATION NOTICE FOR LODE MINING CLAIM

Amendment BLM Serial # _____

NOTICE IS HEREBY GIVEN that the FWG-7

_____ lode mining claim has been located by First Western Gold, Inc whose current mailing address is 24 W. Camelback Rd. - #563 Phoenix, AZ. 85012

RECEIVED
BLM AZ STATE OFFICE
2018 MAY 11 A 11:39
PHOENIX, ARIZONA
BLM
Date
Stamp

The general course of this claim is East/West and it is situated in Gila County, Arizona. This claim is 1500 feet in length and 600 feet in width.

20.6 Total Claim Acreage. This claim runs from the location monument on which this location notice is posted on the centerline of the claim approximately 20 feet in a West direction to the West end line and 1480 feet in a East direction to the East end line. This claim is marked by six monuments, one at each corner and one at the center of each end line of the claim.

The location monument on which this notice is posted is situated within Section 36, Township 7 N, Range 13 E, Gila Salt River Base and Meridian, Arizona and this claim encompasses portions of the following quarter section(s), section(s), Township(s) and Range(s) SW 1/4 and SE 1/4, Sec 36, T7N, R13E

Gila Salt River Base and Meridian, Arizona.

The locality of this claim with reference to some natural object or permanent monument and additional information (if any) concerning its locality are as follows: the SWC bears N82°W, 3594' from the monument at the intersection of T6N, T7N, R13E, R14E

The above information is shown on the attached map.

DATED AND POSTED on the ground this 1 day of MAY, 2018

LOCATOR(s) AGENT

Print Name(s) Alfred DeFalco Pres., F.W.G.

Signature(s) [Handwritten Signature] PRES.

Form MCF100
Revised July 2014

AMC450743

LOCATION NOTICE FOR LODE MINING CLAIM

Amendment BLM Serial # _____

NOTICE IS HEREBY GIVEN that the FWG-8
_____ lode mining claim has been located
by First Western Gold, Inc whose current mailing
address is 24 W. Camelback Rd - #563
Phoenix, AZ. 85012

RECEIVED
PHOENIX, ARIZONA
MAY 11 A.M. 11:39
BLM
Date
Stamp

The general course of this claim is East/West and it is situated in Gila
County, Arizona. This claim is 1500 feet in length and 600 feet in width.

20.6 Total Claim Acreage. This claim runs from the location monument on which this location notice
is posted on the centerline of the claim approximately 1480 feet in a West direction to the West
end line and 20 feet in a East direction to the East end line. This claim is marked by six
monuments, one at each corner and one at the center of each end line of the claim.

The location monument on which this notice is posted is situated within Section 36, Township 7
N, Range 13 E, Gila Salt River Base and Meridian, Arizona and this claim encompasses portions
of the following quarter section(s), section(s), Township(s) and Range(s) SE 1/4, Sec 36, T7N,
R13E

Gila Salt River Base and Meridian, Arizona.

The locality of this claim with reference to some natural object or permanent monument and additional information
(if any) concerning its locality are as follows: The SEC bears N51°-09' W, 725' from
the monument at the intersection of T6N, T7N,
R13E and R14E The above information is shown on the attached map.

DATED AND POSTED on the ground this 1 day of MAY, 2018.

LOCATOR(s) AGENT

Print Name(s) Alfred DeFalso Pres., F.W.G.

Signature(s) [Handwritten Signature]

Form MCF100
Revised July 2014

AMC450744

LOCATION NOTICE FOR LODE MINING CLAIM

Amendment BLM Serial # _____

NOTICE IS HEREBY GIVEN that the FWG-9
_____ lode mining claim has been located
by First Western Gold, Inc whose current mailing
address is 24 W. Camelback Rd - #563
Phoenix, AZ 85012

RECEIVED
M AZ STATE OFFICE
2018 MAY 11 A 11:39
PHOENIX, ARIZONA
BLM
Date
Stamp

The general course of this claim is East/West and it is situated in Gila
County, Arizona. This claim is 1500 feet in length and 600 feet in width.

20.6 Total Claim Acreage. This claim runs from the location monument on which this location notice
is posted on the centerline of the claim approximately 20 feet in a West direction to the West
end line and 1480 feet in a East direction to the East end line. This claim is marked by six
monuments, one at each corner and one at the center of each end line of the claim.

The location monument on which this notice is posted is situated within Section 36, Township 7
N, Range 13 E, Gila Salt River Base and Meridian, Arizona and this claim encompasses portions
of the following quarter section(s), section(s), Township(s) and Range(s) SE 1/4, Sec 36, T7N,
R13E and SW 1/4, Sec 31, T7N, R14E
Gila Salt River Base and Meridian, Arizona.

The locality of this claim with reference to some natural object or permanent monument and additional information
(if any) concerning its locality are as follows: The SWC bears N51°-09'W, 725'
from the monument at the intersection of T7N, T6N,
R13E and R14E The above information is shown on the attached map.

DATED AND POSTED on the ground this 1 day of MAY, 2018

LOCATOR(s) AGENT

Print Name(s) Alfred DeFalco, Pres., F.W.G.
Signature(s) [Handwritten Signature]

Form MCF100
Revised July 2014

AMC450745

LOCATION NOTICE FOR LODE MINING CLAIM

Amendment BLM Serial # _____

NOTICE IS HEREBY GIVEN that the F.W.G-10

_____ lode mining claim has been located

by First Western Gold, Inc whose current mailing address is 24 W. Camelback Rd. - #563

Phoenix, AZ 85012

The general course of this claim is East/West and it is situated in Gila

County, Arizona. This claim is 1500 feet in length and 600 feet in width.

20.6 Total Claim Acreage. This claim runs from the location monument on which this location notice is posted on the centerline of the claim approximately 1480 feet in a West direction to the West end line and 20 feet in a East direction to the East end line. This claim is marked by six monuments, one at each corner and one at the center of each end line of the claim.

The location monument on which this notice is posted is situated within Section 36, Township 7 N, Range 13 E, Gila Salt River Base and Meridian, Arizona and this claim encompasses portions of the following quarter section(s), section(s), Township(s) and Range(s) SW 1/4, Sec 36,
T 7 N, R 13 E

Gila Salt River Base and Meridian, Arizona.

The locality of this claim with reference to some natural object or permanent monument and additional information (if any) concerning its locality are as follows: The SEC bears N 70°-00'W, 3760'
from the monument at the intersection of T 7 N, T 6 N,
R 13 E and R 14 E The above information is shown on the attached map.

DATED AND POSTED on the ground this 1 day of MAY, 2018

LOCATOR(s) AGENT

Print Name(s) Alfred DeFabo, Pres., F.W.G.

Signature(s) [Handwritten Signature] PRET.

RECEIVED
BLM STATE OFFICE
2018 MAY 11 A 11:39
PHOENIX, ARIZONA

BLM
Date
Stamp

AMC450746

Form MCF100
Revised July 2014

LOCATION NOTICE FOR LODE MINING CLAIM

Amendment BLM Serial # _____

NOTICE IS HEREBY GIVEN that the FWG-11

_____ lode mining claim has been located

by First Western Gold, Inc whose current mailing

address is 24 W. Camelback Rd - #563

Phoenix, AZ 85012

The general course of this claim is East/West and it is situated in Gila

County, Arizona. This claim is 1500 feet in length and 600 feet in width.

20.6 Total Claim Acreage. This claim runs from the location monument on which this location notice is posted on the centerline of the claim approximately 20 feet in a West direction to the West end line and 1480 feet in a East direction to the East end line. This claim is marked by six monuments, one at each corner and one at the center of each end line of the claim.

The location monument on which this notice is posted is situated within Section 36, Township 7 N, Range 13 E, Gila Salt River Base and Meridian, Arizona and this claim encompasses portions of the following quarter section(s), section(s), Township(s) and Range(s) SW 1/4 and SE 1/4, Sec 36, T7N, R13E

Gila Salt River Base and Meridian, Arizona.

The locality of this claim with reference to some natural object or permanent monument and additional information (if any) concerning its locality are as follows: The SWC bears N 70°-00' W, 3760'
from the monument at the intersection of T6N, T7N,
R13E and R14E. The above information is shown on the attached map.

DATED AND POSTED on the ground this 1 day of MAY, 20 18

LOCATOR(s) AGENT

Print Name(s) Alfred DeFalco, Pres., F.W.G.

Signature(s) [Handwritten Signature]

RECEIVED
BLM STATE OFFICE
PHOENIX, ARIZONA
MAY 11 A 11:39

BLM
Date
Stamp

AR450747

LOCATION NOTICE FOR LODE MINING CLAIM

Amendment BLM Serial # _____

NOTICE IS HEREBY GIVEN that the FWG-12

_____ lode mining claim has been located

by First Western Gold, Inc whose current mailing address is 24 W. Camelback Rd. - #563

Phoenix, AZ 85012

RECEIVED
BLM STATE OFFICE
2018 MAY 11 A 11:39
PHOENIX, ARIZONA
BLM
Date
Stamp

The general course of this claim is East/West and it is situated in Gila

County, Arizona. This claim is 1500 feet in length and 600 feet in width.

20.6 Total Claim Acreage. This claim runs from the location monument on which this location notice is posted on the centerline of the claim approximately 1480 feet in a West direction to the West end line and 20 feet in a East direction to the East end line. This claim is marked by six monuments, one at each corner and one at the center of each end line of the claim.

The location monument on which this notice is posted is situated within Section 36, Township 7 N, Range 13 E, Gila Salt River Base and Meridian, Arizona and this claim encompasses portions of the following quarter section(s), section(s), Township(s) and Range(s) SE 1/4, Sec. 36,
T7N, R13E

Gila Salt River Base and Meridian, Arizona.

The locality of this claim with reference to some natural object or permanent monument and additional information (if any) concerning its locality are as follows: The SEC bears N23°W, 1407'
from the monument at the intersection of T6N, T7N,
R13E, and R14E The above information is shown on the attached map.

DATED AND POSTED on the ground this 1 day of MAY, 2018

LOCATOR(s) AGENT

Print Name(s) Alfred DeFalco Pres., F.W.G.

Signature(s) [Signature] Pres.

Form MCF100
Revised July 2014

AMC450748

LOCATION NOTICE FOR LODE MINING CLAIM

Amendment BLM Serial # _____

NOTICE IS HEREBY GIVEN that the FWG-13

_____ lode mining claim has been located

by First Western Gold, Inc whose current mailing

address is 24 W, Camelback Rd. - #563

Phoenix, AZ. 85012

The general course of this claim is East/West and it is situated in Gila

County, Arizona. This claim is 1500 feet in length and 600 feet in width.

20.6 Total Claim Acreage. This claim runs from the location monument on which this location notice is posted on the centerline of the claim approximately 20 feet in a West direction to the West end line and 1480 feet in a East direction to the East end line. This claim is marked by six monuments, one at each corner and one at the center of each end line of the claim.

The location monument on which this notice is posted is situated within Section 36, Township 7 N, Range 13 E, Gila Salt River Base and Meridian, Arizona and this claim encompasses portions of the following quarter section(s), section(s), Township(s) and Range(s) SE 1/4, Sec 36, T7N, R13E
SW 1/4, Sec. 31, T7N, R14E

Gila Salt River Base and Meridian, Arizona.

The locality of this claim with reference to some natural object or permanent monument and additional information (if any) concerning its locality are as follows: The SWC bears N23°W, 1407'
from the monument at the intersection of T7N,
T6N, R13E, and R14E The above information is shown on the attached map.

DATED AND POSTED on the ground this 1 day of MAY, 2018.

LOCATOR(s) AGENT

Print Name(s) Alfred DeFalco Pres., F.W.G.

Signature(s) [Signature]

RECEIVED
BLM ARIZONA STATE OFFICE
2018 MAY 11 A 11:39
PHOENIX, ARIZONA

BLM
Date
Stamp

AN0450749

Form MCF100
Revised July 2014

LOCATION NOTICE FOR LODE MINING CLAIM

Amendment BLM Serial # _____

NOTICE IS HEREBY GIVEN that the FWG 100
_____ lode mining claim has been located

by FIRST WESTERN GOLD INC whose current mailing
address is 24 W. CAMELBACK RD A 563
PHOENIX, ARIZONA 85013.

The general course of this claim is EAST/WEST and it is situated in GILA
County, Arizona. This claim is 1500 feet in length and 600 feet in width.

20.00 Total Claim Acreage. This claim runs from the location monument on which this location notice
is posted on the centerline of the claim approximately 1480 feet in a WEST direction to the WEST
end line and 20 feet in a EAST direction to the EAST end line. This claim is marked by six
monuments, one at each corner and one at the center of each end line of the claim.

The location monument on which this notice is posted is situated within Section 36, Township 7 N
_____, Range 13 E, Gila Salt River Base and Meridian, Arizona and this claim encompasses portions
of the following quarter section(s), section(s), Township(s) and Range(s) SW 1/4, SEC 36, T7N, R13E
AND SE 1/4, SEC 35, T7N, R13E
Gila Salt River Base and Meridian, Arizona.

The locality of this claim with reference to some natural object or permanent monument and additional information
(if any) concerning its locality are as follows: THE EEC OF THIS CLAIM BEARS

N 75° 02' W, 4967' FROM THE MONUMENT AT THE INTERSECTION OF
T6N, T7N, R13E, R14E The above information is shown on the attached map.

DATED AND POSTED on the ground this 1 day of MAY, 2018

LOCATOR(s) AGENT

Print Name(s) FIRST WESTERN GOLD INC.

Signature(s) [Signature] PRES.

RECEIVED
BLM STATE OFFICE
2018 MAY 11 A 11:39
PHOENIX, ARIZONA

BLM
Date
Stamp

Form MCF100
Revised July 2014

OF ANCH50750

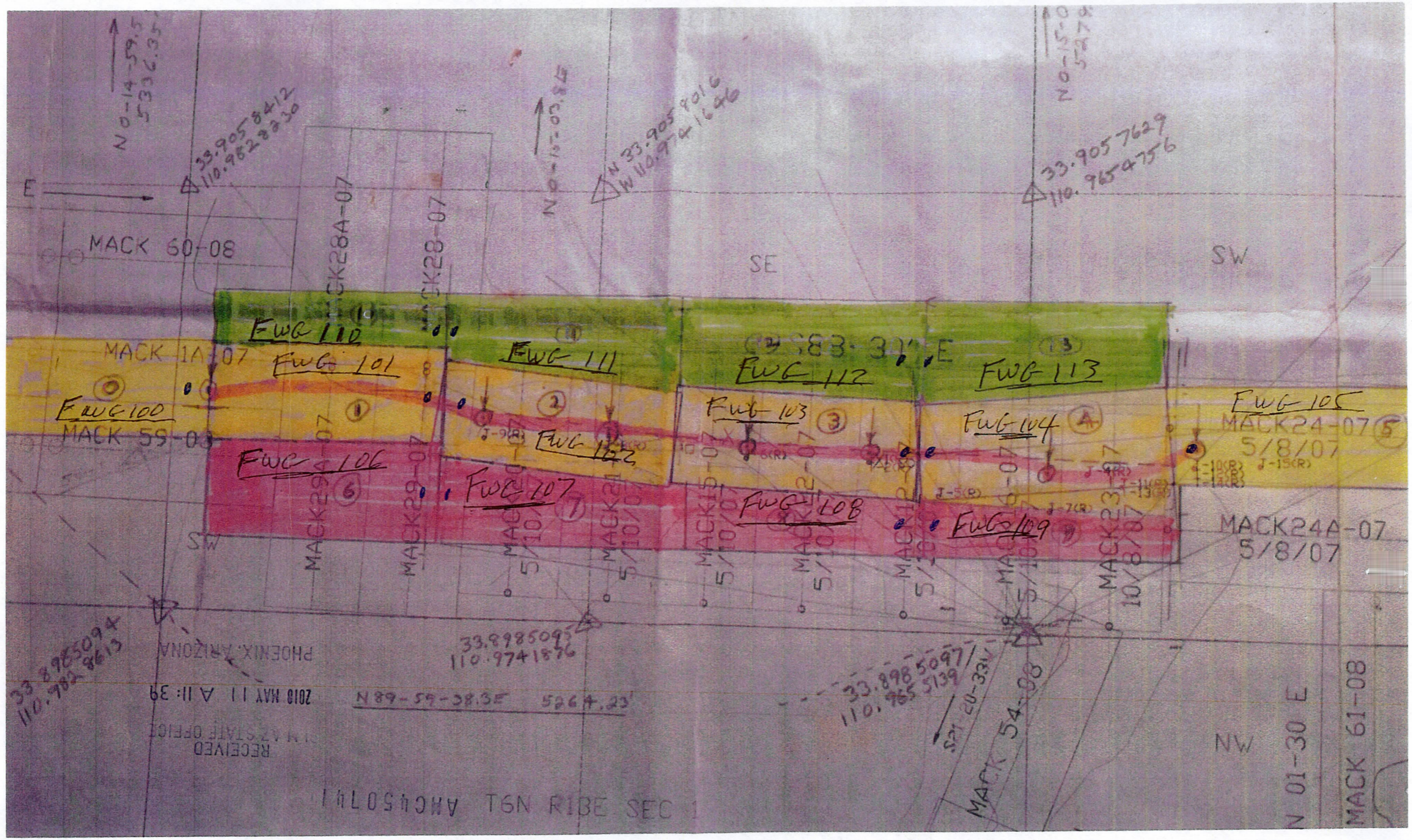

N 0-14-59.5
5336.35

N 33.9058412
W 110.9528830

N 0-15-03.84

N 33.9059016
W 110.9741646

N 0-15-0
5279

N 33.9057629
W 110.9654756

MACK 60-08

MACK 28A-07

MACK 28-07

SE

SW

FWG 110

FWG 111

FWG 112

FWG 113

FWG 100

FWG 101

FWG 102

FWG 103

FWG 104

FWG 105

MACK 59-03

FWG 106

FWG 107

FWG 108

FWG 109

MACK 24-07

MACK 24A-07

MACK 29-07

MACK 29-07

MACK 21-07

MACK 21-07

MACK 13-07

MACK 12-07

MACK 12-07

MACK 9-07

MACK 23-07

RECEIVED
PHOENIX, ARIZONA
MAY 11 A 11:39
STATE OFFICE

N 89-59-58.3E 5264.23

N 33.8985097
W 110.9741576

N 33.8985097
W 110.9655139

MACK 54-08

NW

N 01-30 E

MACK 61-08

ANCHORAGE T6N R1E SEC 1

Input Parameters for Geographic Report with Land

System Id = CR

Admin State = AZ

Geo State =

Casetype Begins With

Case Disp Txt = AUTHORIZED, CANCELLED, EXPIRED, PENDING, REJECTED, RELINQUISHED, VOID, WITHDRAWN

Mer Twp Rng =

Section =

Mtrs = 14 0070N 0130E 036, 14 0070N 0130E 999, 14 0070N 0140E 031, 14 0070N 0140E 999

Commodity =

Commodity Txt =

Pending Org =

Pend Org Decode =

Total Rows Returned: 0

TOWNSHIP 07 NORTH RANGE 13 EAST OF THE GILA & SALT RIVER MERIDIAN, ARIZONA

SECS	SUBDIVISION																Acres	Kind of Entry or Purpose	Serial Number or Order Number	Action Date	Remarks		
	NE 1/4				NW 1/4				SW 1/4				SE 1/4									Lots	Other Description
	NE	NW	SW	SE	NE	NW	SW	SE	NE	NW	SW	SE	NE	NW	SW	SE							
For orders affecting disposal or use of unidentified lands withdrawn for classification, minerals, water, and/or other public purposes, and Indian treaties, refer to Index to Miscellaneous Documents																							
	ENTIRE TOWNSHIP																	13N 1E;		SO TEMP WDL RIO VERDE FOREST RESERVE		12/14/1901	WDL PROC 10/3/1905;
	ENTIRE TOWNSHIP																	11N 7E;		PROC WDL TONTO FOREST RESERVE		10/3/1905	CHANGED TO TONTO NF ACT 3/4/1907;
13													X	X	X	X		160.00	SO WDL TURKEY SPRING SITE		7/17/1908	SO REV 10/31/1913;	
																		ALL SECS 2, 16, 32, 36;		STATE GRANT	ACT OF CONGRESS	6/20/1910	TITLE TO STATE TO FIX ON APPROVAL OF SURVEY, SUBJECT TO PRIOR RIGHTS;
13													X	X	X	X		160.00	SO REV WDL TURKEY SPRING SITE, SO 7/17/1908		10/31/1913	21N 6E;	
29																		M&B;					
30																		M&B;					
31																		M&B;					
32																		M&B;	79.50	HE	PHX-030984	2/10/1917	REL 12/17/1917;
29																							
30																							
31																							
32																		HES 562;	82.91	PATENT / HE	814553	7/15/1921	7N 12E;
2	X	X	X		X	X	X	X	X	X	X	X	X	X	X	X		629.14	PART SENW;				
16	X				X	X	X	X	X	X	X	X						364.31	PART NWNE;				
32	X	X	X	X	X	X	X	X	X	X	X	X			X	X		626.44	PART NWSE;				
36																		ALL;	640.00	L BASE	55	3/22/1922	8S 13W;
16		X	X										X	X	X	X		240.00	L BASE	65	11/10/1922	16S 19E;	
																		ALL SECS 2, 16, 32, 36;		STATE GRANT	ACT OF CONGRESS	1/25/1927	EXTENDS ACT OF 6/20/1910 TO MINERAL LANDS, SUBJECT TO PRIOR RIGHTS;
2																		PART SENE;	10.88				
16																		PART NWNE;	35.69				
32																		PART NWSE;	13.56	L BASE	136	5/21/1935	5S 12E;
	ENTIRE TOWNSHIP																	7N 12E;		DETERMINATION AREA PL 167	AR-018061	4/24/1958	DET COMP 7/1/1965;
36																		SENE, NESENE;	20.00	APLN / WDL FS MCFADDEN PEAK LOOKOUT ADMIN SITE	AR-033067	11/4/1963	WDL PLO 3965, 3/30/1966;
36																			20.00	PLO WDL FS MCFADDEN PEAK LOOKOUT ADMIN SITE	3965	3/30/1966	10N 4E;
32																		M&B;					

TOWNSHIP 07 NORTH RANGE 13 EAST OF THE GILA & SALT RIVER MERIDIAN, ARIZONA

SECS	SUBDIVISION																Acres	Kind of Entry or Purpose	Serial Number or Order Number	Action Date	Remarks		
	NE 1/4				NW 1/4				SW 1/4				SE 1/4									Lots	Other Description
	NE	NW	SW	SE	NE	NW	SW	SE	NE	NW	SW	SE	NE	NW	SW	SE							
For orders affecting disposal or use of unidentified lands withdrawn for classification, minerals, water, and/or other public purposes, and Indian treaties, refer to Index to Miscellaneous Documents																							
33																		M&B;					
34																		M&B;	DES SALOME WILDERNESS AREA, PL 98-406	A-6216	8/24/1984	WDN FROM MINING AND MINERAL LEASING; PERPETUAL;	
32									X				X	X	X	X							
33									X	X	X	X	X	X	X	X							
34											X								WDL SALOME WILDERNESS AREA, PL 98-406	A-35485	8/28/1984	IN LIEU OF A-6216; SEGREGATED FROM THE PUBLIC LAND LAWS AND MINING LAWS, INCLUDING THE MINERAL LEASING LAWS; PERPETUAL LD TP: 5N 12E;	
																		PART HES 562;	WD RECON TO US	AZA-24271	11/26/1991	LD TP: 6N 12E;	

TOWNSHIP 07 NORTH RANGE 14 EAST OF THE GILA & SALT RIVER MERIDIAN, ARIZONA

SECS	SUBDIVISION																Acres	Kind of Entry or Purpose	Serial Number or Order Number	Action Date	Remarks			
	NE 1/4				NW 1/4				SW 1/4				SE 1/4									Lots	Other Description	
	NE	NW	SW	SE	NE	NW	SW	SE	NE	NW	SW	SE	NE	NW	SW	SE								
For orders affecting disposal or use of unidentified lands withdrawn for classification, minerals, water, and/or other public purposes, and Indian treaties, refer to Index to Miscellaneous Documents																								
	ENTIRE TOWNSHIP																	13N 1E;		SO TEMP WDL RIO VERDE FOREST RESERVE		12/14/1901	WDL PROC 10/3/1905;	
	ENTIRE TOWNSHIP																	11N 7E;		PROC WDL TONTO FOREST RESERVE		10/3/1905	CHANGED TO TONTO NF ACT 3/4/1907;	
																		ALL SECS 2, 16, 32, 36;		STATE GRANT	ACT OF CONGRESS	6/20/1910	TITLE TO STATE TO FIX ON APPROVAL OF SURVEY; SUBJECT TO PRIOR RIGHTS;	
36	X	X	X	X	X	X	X	X										PART NESE;	324.63	IL BASE	55	3/22/1922	8S 13W;	
16	X	X	X	X	X	X	X	X	X	X	X	X	X						520.00					
32																		ALL;	640.00	IL BASE	65	11/10/1922	16S 19E;	
2								X	X	X	X	X	X	X	X	X			320.00	IL BASE	70	4/13/1923	13N 7W;	
16														X	X			PART NWSE;	105.96	IL BASE	76	9/5/1923	21S 11E;	
2	X	X	X	X			X	X										PART NENW, NWNW;	313.63					
36								X	X	X	X	X	X	X	X	X		PART NESE;	280.59	IL BASE	83	5/6/1925	11N 3E;	
																		ALL SECS 2, 16, 32, 36;		STATE GRANT	ACT OF CONGRESS	1/25/1927	EXTENDS ACT OF 6/20/1910 TO MINERAL LANDS; SUBJECT TO PRIOR RIGHTS;	
36																		PART NESE;	23.76	IL BASE	136	5/21/1935	5S 12E;	
16																		PART NWSE;	14.04	IL BASE	142	7/8/1935	21S 23E;	
36																		PART NESE;	11.02	IL BASE	183	10/31/1938	11S 19E;	
	ENTIRE TOWNSHIP																	7N 12E;		DETERMINATION AREA PL 167	AR-018061	4/24/1958	DET COMP 7/11/1965;	
2																		PART NWNW, NENW;	6.37	IL BASE	310	8/8/1963	9N 3E;	
31																		SWNWNW, NWSWNW;	20.00	APLN / WDL FS MCFADDEN PEAK LOOKOUT ADMIN SITE	AR-033067	11/4/1963	WDL PLO 3965, 3/30/1966; 10N 4E;	
20																		M&B;						
21																		M&B;						
27																		M&B;						
28																		M&B;						
29																		M&B;						
32																		ALL;						
33																		ALL;						
34																		M&B;		DES SIERRA ANCHA WILDERNESS AREA, PL 88-577	A-6216	9/3/1964	WDN FROM MINING AND MINERAL LEASING; LD TP: 5N 14E;	
31																		SWNWNW, NWSWNW;	20.00	PLO WDL FS MCFADDEN PEAK LOOKOUT ADMIN SITE	3965	3/30/1966	10N 4E;	

TOWNSHIP 07 NORTH RANGE 14 EAST OF THE GILA & SALT RIVER MERIDIAN, ARIZONA

SECS	SUBDIVISION																Acres	Kind of Entry or Purpose	Serial Number or Order Number	Action Date	Remarks		
	NE 1/4				NW 1/4				SW 1/4				SE 1/4									Lots	Other Description
	NE	NW	SW	SE	NE	NW	SW	SE	NE	NW	SW	SE	NE	NW	SW	SE							
For orders affecting disposal or use of unidentified lands withdrawn for classification, minerals, water, and/or other public purposes, and Indian treaties, refer to Index to Miscellaneous Documents																							
22																		M&B; RICK TICK NOS 1, 2, 3, 4, RIAN NOS 1, 2, LADY ESTHER 1, 2, 3, JOE BLAIR LODE CLAIMS;		US VS MINING LOCATION	A-10808	4/20/1978	FS; COMPLAINT DISMISSED; CONTEST CLOSED;
30																		W2SENESE, E2SWNESE, NWNESESE, NENWSESE;		WDL / PROPOSED	AZA-30389	10/9/1997	SEGREGATES THE LAND FROM ENTRY AND LOCATION UNDER THE US MINING LAWS; TO TERM 10/8/1999; APLN WDN; CASE CLOSED 6/10/2004;